



FISH TRAP BUILD VIDEO



RANGER XT THERMAL

SPECIFICATIONS

- Part Number: 118593
- Set Up Size: 96"L x 61"W x 75"H
- Packed Size: 61"L x 35"W x 23"H
- Weight: 92lbs.
- Fishable Area: 24 sq.ft
- Instructions: 107574

CLAMOUTDOORS.COM

MODEL 18593

WARRANTY INFORMATION



Please contact customer service directly at the E-mail or phone number listed below for any quality issues. **ONCE USED THIS PRODUCT CANNOT BE RETURNED TO STORE.**

***** Warranty cannot be honored without an original, dated receipt *****

***** REGISTER YOUR PURCHASE ONLINE AT CLAMOUTDOORS.COM *****

IMPORTANT-PLEASE READ:

This product is warranted to the original retail purchaser (from an authorized dealer) and is non-transferable. Clam Outdoors has a three-year **manufacturer's defect warranty** from the date of original purchase. Warranty does not cover cracked or worn bases (**if runner kits have not been installed as recommended**), cracked windows, tent tears or cuts, or broken or bent hoops due to high wind weather conditions or unattended use. Defective parts will be replaced or repaired (at the manufacturer's option) if found to be defective within three years from the date of original purchase. Warranty will be void if product has been subject to neglect, misuse, improper installation, misapplication, alteration, accident including but not limited to improper maintenance, or use of unauthorized parts or attachments. Please read the entire owner's manual to ensure proper installation, use, storage and care of your Clam Shelter.

To submit a warranty claim request, please use one of the following methods:

- <https://clamoutdoors.com/pages/warranty-form>
- Email: customerservice@clamcorp.com

In your request, please include your full name, address, phone number, a copy of your receipt, a brief description of the problem, and pictures to clearly show the area(s) of concern. Our Warranty Department will review your request, and a Clam representative will contact you regarding your claim status. All returns must be shipped to us postage pre-prepaid.

LIMITATION OF LIABILITY

It is expressly understood that Clam Outdoors Inc., liability for its products, whether due to breach of warranty, negligence, strict liability, or otherwise, is limited to the repair of the product as stated above. Clam is not liable for any injury, loss, damage, or expense, whether direct or consequential, including but not limited to loss of use, income, profit, or damage to material arising in connection with the sale, installation, use of, inability to use, or the repair or replacement of Clam products. Clam reserves the right to make alterations or modifications in its products at any time, which in its opinion, may improve the performance and efficiency of the product. Clam shall not be obligated to make such alterations or modifications to products already in service

Clam contact information

Customer Service Hrs: 9am to 4pm, Monday – Friday Central Standard Time
Clam Outdoors

Attn: Customer Service

12135 Brockton Lane

Rogers, MN 55369

Phone: 763-231-4120

PARTS LIST

QTY.	PART NO.	DESCRIPTION
1	107573	BASE, RANGER
1	107470	EXTENSION HOOP POLE, RANGER XT (GREEN ZIP TIE)
2	107469	HOOP POLE, RANGER XT
2	107460	HALF HOOP POLE, RANGER XT
1	114271	LARGE DIMMABLE LIGHT STICK
1	107471	TENT, RANGER XT THERMAL
1	108829	BATTERY BRACKET/HARDWARE
2	107351	SEAT COVER BACK
2	107352	SEAT COVER BOTTTOM
1	101840	REAR ADJUSTABLE SPREADER POLE
2	102759	DELUXE SEAT
1	102814	U-CHANNEL
1	107617B	TRAVEL COVER, RANGER XT THERMAL, ICE OPS
1	106410	LIGHT CORD STORAGE BAG
1	101095	TOW ROPE, 3/8 DIA X 9 FT
1	107574	INSTRUCTION, RANGER XT THERMAL
1	107465	INNERPACK, RANGER XT, BOX 1 OF 2 (INCLUDES THE FOLLOWING)
2	106800	MOUNTING BRACKET
8	103605	LARGE RPSX COLLAR, 1 1/4" POLE
4	106004	CHAIR LEG
4	106003	CHAIR LEG BASE
2	105478	SEAT SWIVEL
2	106007	SEAT BRACKET
2	106784	EXTENSION CLAMP
1	107467	KIT, HRDWR, RANGER XT (INCLUDES THE FOLLOWING)
44	106284	NUT, 1/4-20, FLANGE, NYLOCK
23	101148	SCREW, #6 X 0.38 PPH BZ
9	101470	SCREW, 1/4-20 X 0.50 SER HXFLGHD GR5
23	101081	WASHER, 1/4 FLAT REG YZ
5	105794	BOLT, 1/4-20 X .75, HEX HEAD
26	106456	SCREW, 1/ 4-20 X 1.75, BTN, HEX DRIVE
8	106286	SCREW, 1/4-20 X 0.75, BTN, HEX DRIVE
8	106331	SCREW, 1/4-20 X 2.50, PT, BTN, HEX DRIVE
1	106294	ALLEN WRENCH, 5/32 HEX DRIVE, L-SHAPE, 1/4 THREADS
1	107468	INNERPACK, RANGER XT, BOX 2 OF 2 (INCLUDES THE FOLLOWING)
2	106896	EXTENSION SUPPORT POLE, RANGER XT
4	103599	STRAIGHT CANOPY SUPPORT POLE
2	107498	BENT PORCH SUPPORT POLE

Please Notice This



- EXTRA FASTENERS INCLUDED WITH THE HARDWARE KIT #107467
- INSTALL ANY RUNNER KIT OPTIONS BEFORE ASSEMBLING SHELTER
- USING A DROP OF OIL ON ALL NUTS WILL EASE THE ASSEMBLY

HARDWARE FASTENERS REFERENCE



19X 101148



7X 101082

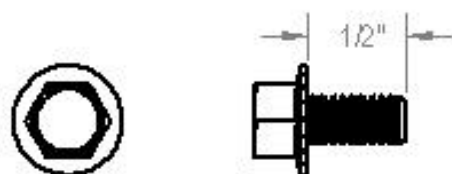

9X 101470



37X 106284

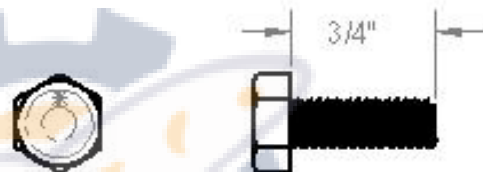

6X 105794



31X 101081



5X 106286



4X 103839

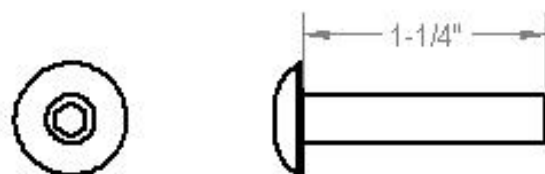

7X 106455

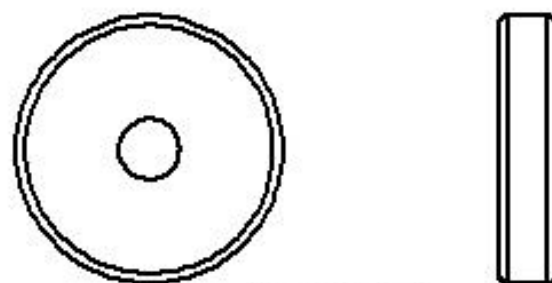

2X 103835

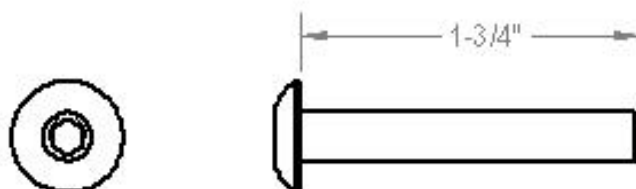

29X 106456

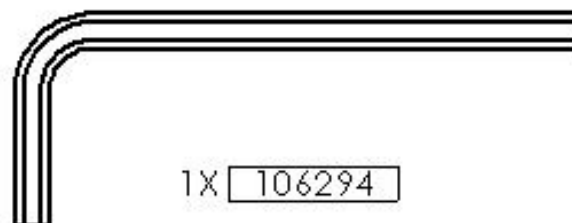

1X 106294

STEP 1 – SEAT ASSEMBLY

Parts Needed for Step 1

Part Number	Description	Quantity
106003	CHAIR LEG BASE	4
106004	CHAIR LEG	4
102759	DELUXE SEAT	2
105478	SEAT SWIVEL	2
107351	SEAT COVER BACK	2
107352	SEAT COVER BOTTOM	2
101470	SCREW, 1/4-20 X 0.50	8
106456	SCREW, 1/ 4-20 X 1.75	24
101081	WASHER, 1/4 FLAT	24
106284	NUT, 1/4-20, NYLOCK	24

A. Connect the Chair Leg Base #106003 to the Chair Legs #106004, with the base bracket on the **INSIDE** of the legs (see photo), using the #106456 bolts, #101081 washers and #106284 nuts. **NOTE: HEAD OF BOLTS FACING OUTWARD**

B. Tighten hardware using a 7/16" wrench or socket.

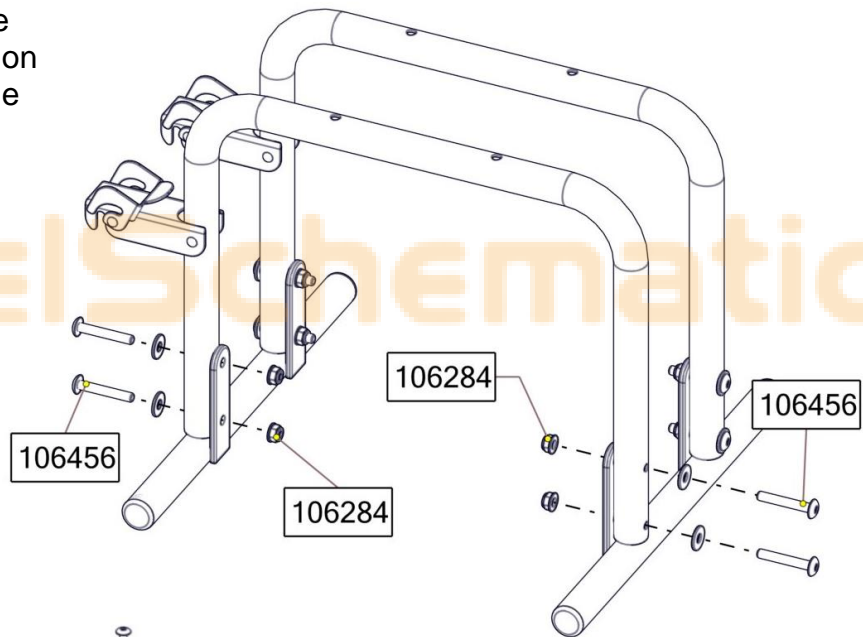

C. Rotate Seat Swivel #105478 45 degrees so its star shaped and all slotted holes are accessible.

D. Secure the Seat Swivel to the Chair Legs using #106456 bolts, #101081 washers and #106284 nuts and tighten.

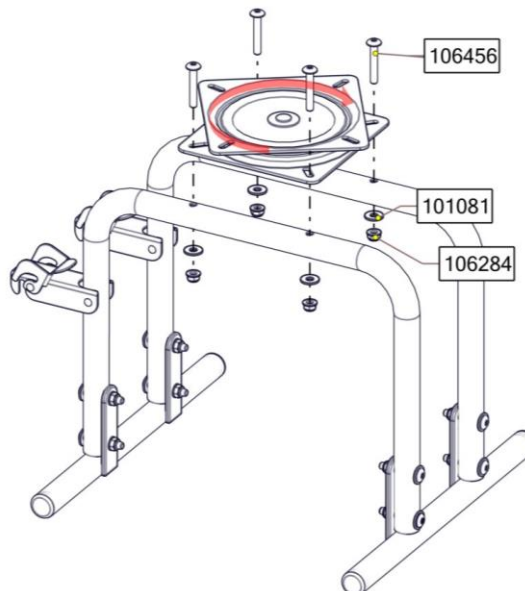

E. Flip the Deluxe Seat #102759 upside down and attach the swivel assembly to the bottom of the seat using #101470 bolts and tighten with a 3/8" wrench or socket.

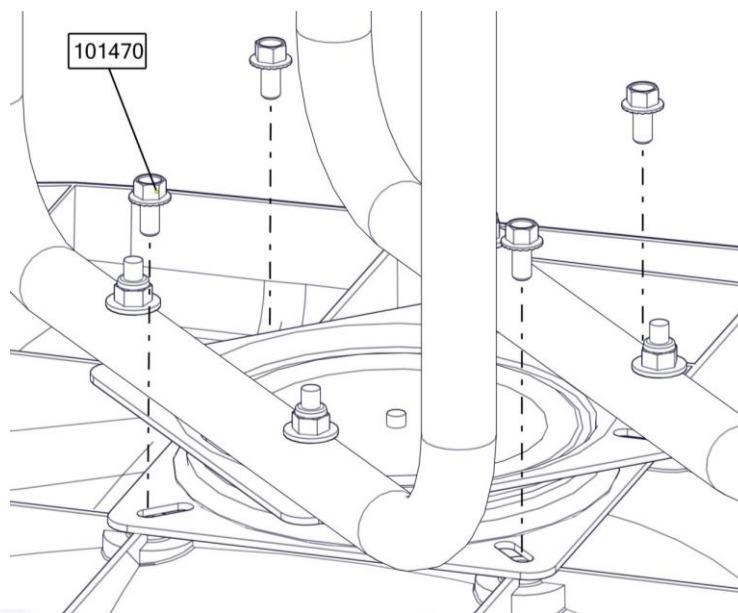

F. Insert Seat Cover Back #107351 and Bottom #107352 onto completed seat assembly, starting with the bottom cushion, and secure Velcro.

G. Repeat Step 1 to complete second seat assembly.

ReelSchematic

Completed Seat Assembly

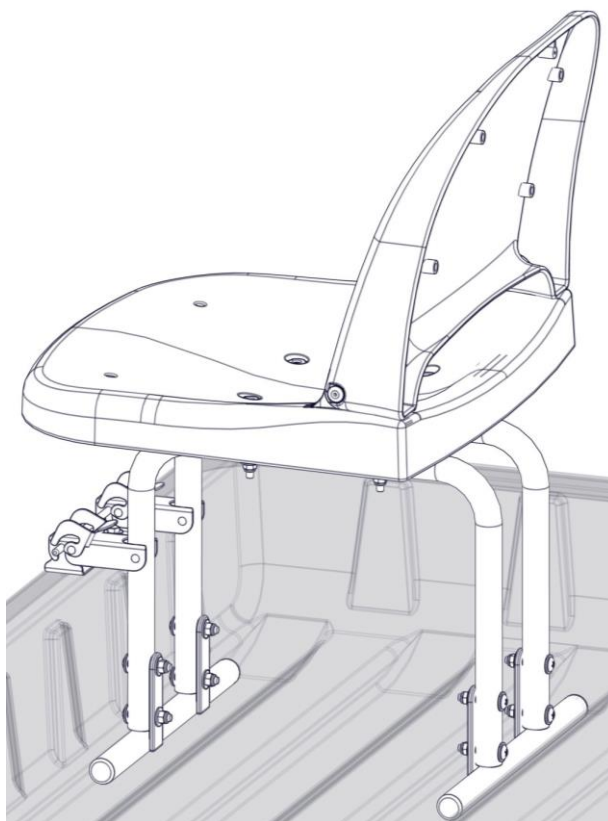

STEP 2 – LIGHT STICK HOOP ASSEMBLY

Parts Needed for Step 2

Part Number	Description	Quantity
107460	HALF HOOP POLE	2
114271	LARGE LIGHT STICK	1
106410	LIGHT CORD STORAGE BAG	1

- A. Install Light Stick #114271 into the #107460 Half Hoop Poles to make the light stick hoop assembly. Hardware to assemble is included with the light stick.

NOTE: Be mindful of where you will be installing the included Battery Bracket as the light stick cord should face that direction.

- B. Attach Light Cord Storage Bag #106410 to pole assembly.

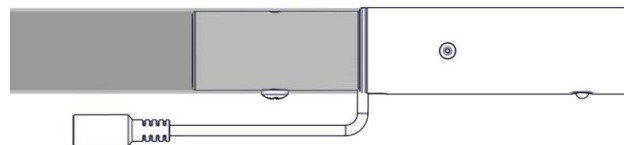
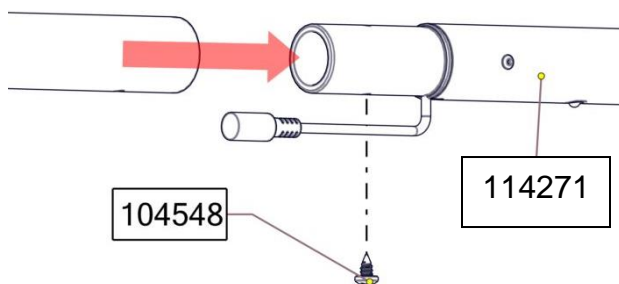
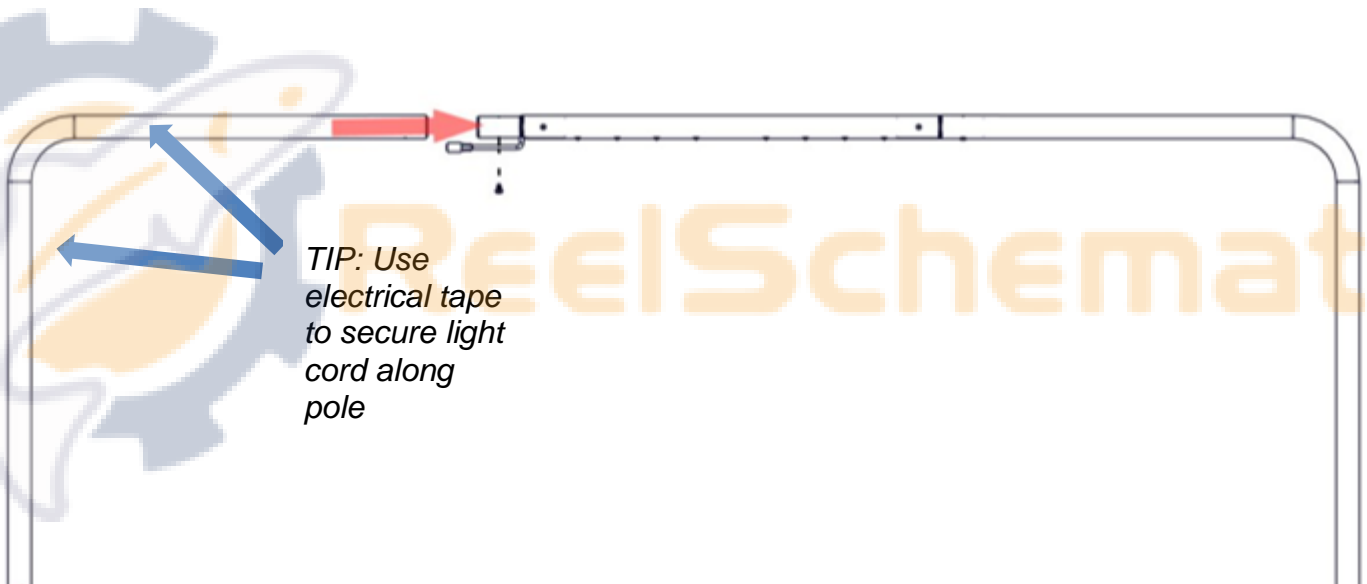

STEP 3 – EXTENSION HOOP POLE ASSEMBLY



DO NOT CUT ANY OF YOUR POLES

NOTE: The Extension Hoop Pole #107470 is identified with a **green zip tie**. This pole is also shorter in length than the other hoop poles included with the shelter.

Parts Needed for Step 3

Part Number	Description	Quantity
107470	EXTENSION HOOP POLE (Green Zip Tie)	1
N/A	LIGHT STICK HOOP POLE ASSEMBLY (From Step 2)	1
106896	EXTENSION SUPPORT POLE	2
106784	EXTENSION CLAMP	2
103605	LARGE RPSX COLLAR	4

- A. Remove included hardware from the Extension Clamps #106784.
- B. Clip an Extension Clamp around the Light Stick Hoop Pole Assembly from Step 2 with the molded coupling situated towards the inside. Slide clamp into place and snap into the respective hole on the hoop pole. Repeat this process on other side.
- C. Install two RPSX Collars #103605 onto the ends of the Light Stick Hoop Pole.

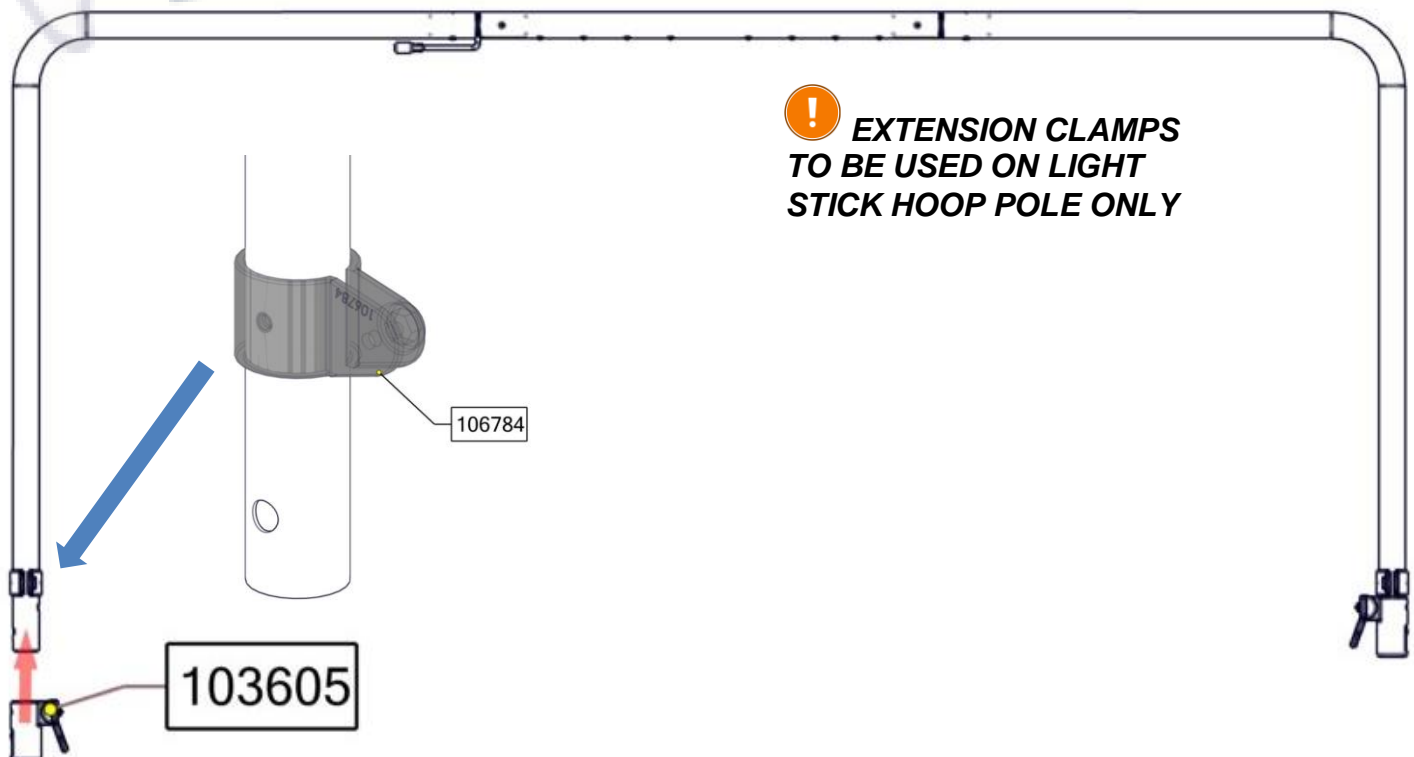

TIP: Twist the lever on the RPSX Collars 90 degrees to allow for easier installation onto Hoop Pole.



Align RPSX Collar with the holes in the Hoop Pole as shown

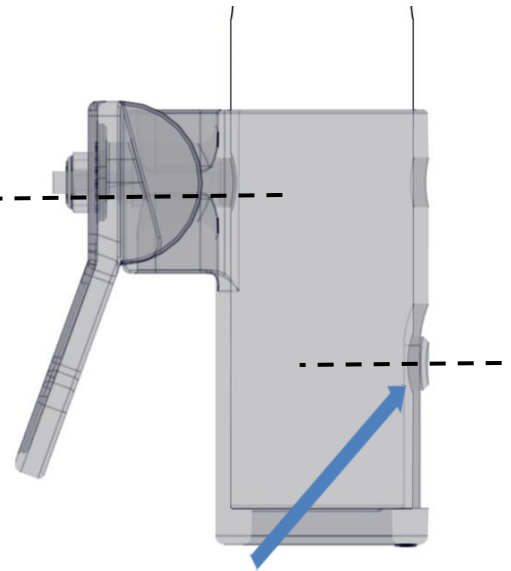

Collar tab is placed on inside of tube

- D. Attach Extension Support Poles #106896 with the notch of the pole facing inward. Use hardware provided with the Extension Clamps to secure. *NOTE: Do not overtighten as this pole needs to move freely.***

Hardware included with Extension Clamp

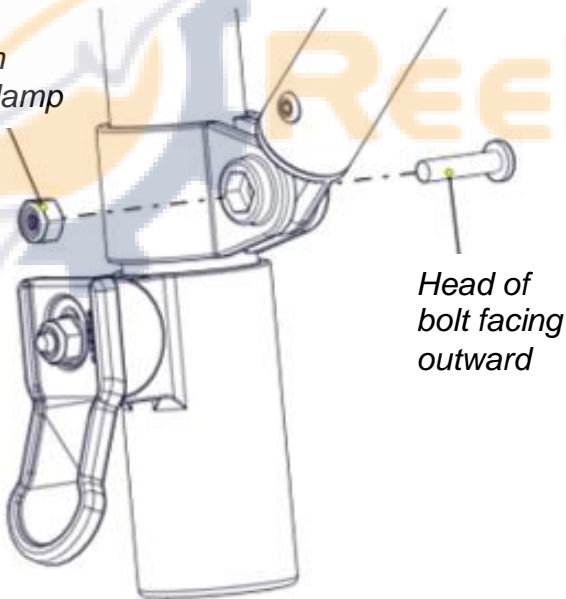

Head of bolt facing outward

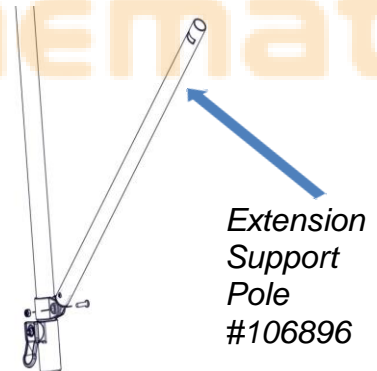

Extension Support Pole #106896

- E. Remove green zip tie on Extension Hoop Pole #107470 and two install RPSX Collars #103605 onto the ends.**
- F. Install Extension Hoop Pole onto Extension Support Poles (see completed example on next page).**

Extension
Hoop Pole
#107470

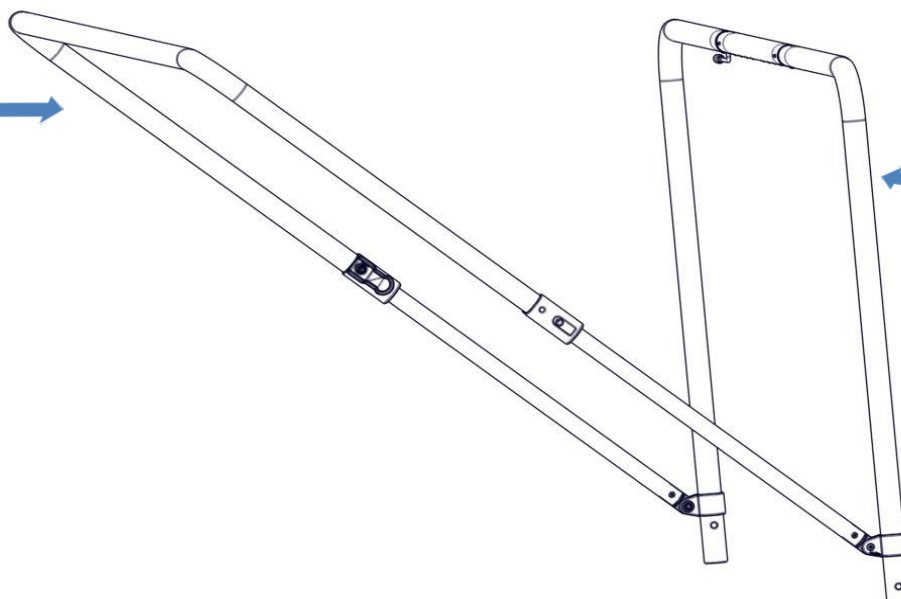

Light Stick
Hoop Pole
Assembly



STEP 4 – SEAT BRACKETS

Parts Needed for Step 4

Part Number	Description	Quantity
106007	SEAT BRACKET	2
105794	BOLT, 1/4-20 X .75	4
101081	WASHER, 1/4 FLAT	4
106284	NUT, 1/4-20, NYLOCK	4

- A. Line up Seat Bracket #106007 with predrilled holes on front lip of sled.
- B. Secure bracket using #105794 bolts, #101081 washers and #106284 nuts.
- C. Repeat for second Seat Bracket.

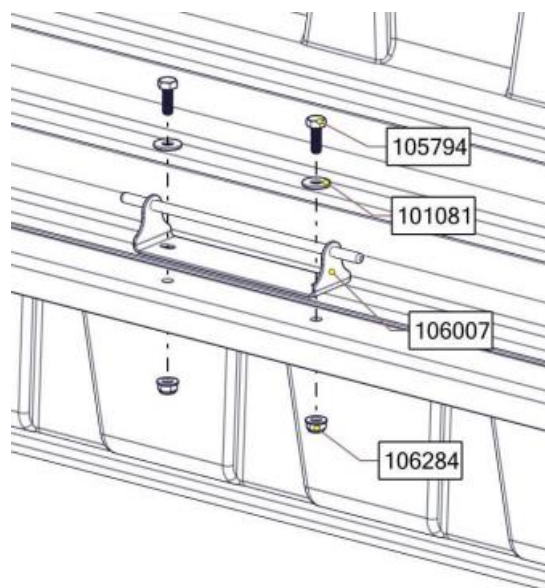

STEP 5 – POLE MOUNTING BRACKETS

Parts Needed for Step 5

Part Number	Description	Quantity
106800	MOUNTING BRACKET	2
106286	SCREW, 1/4-20 X 0.75	6
106284	NUT, 1/4-20, NYLOCK	6

- A. Line up Mounting Bracket #106800 with predrilled holes on end of sled.
- B. Secure bracket using #106286 bolts and #106284 nuts.
- C. Repeat for second Mounting Bracket on opposite end of sled.

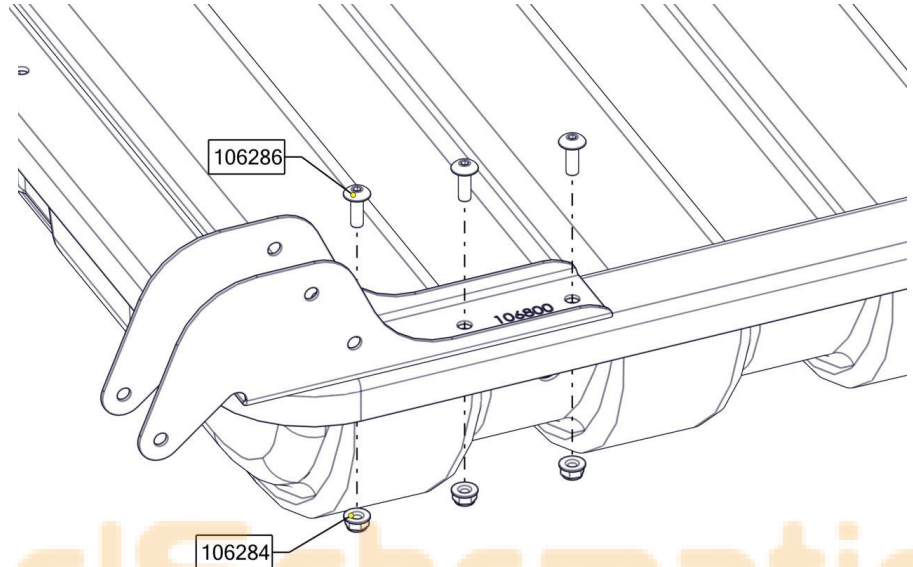

STEP 6 – BATTERY BRACKET

- A. Choose which location you'd prefer to have the battery located (battery not included). **Light stick cord will need to be able to reach battery.**
- B. Install Battery Bracket #108829 as shown below. Refer to the installation manual included with the bracket kit for additional information. Hardware for bracket is included in the kit.

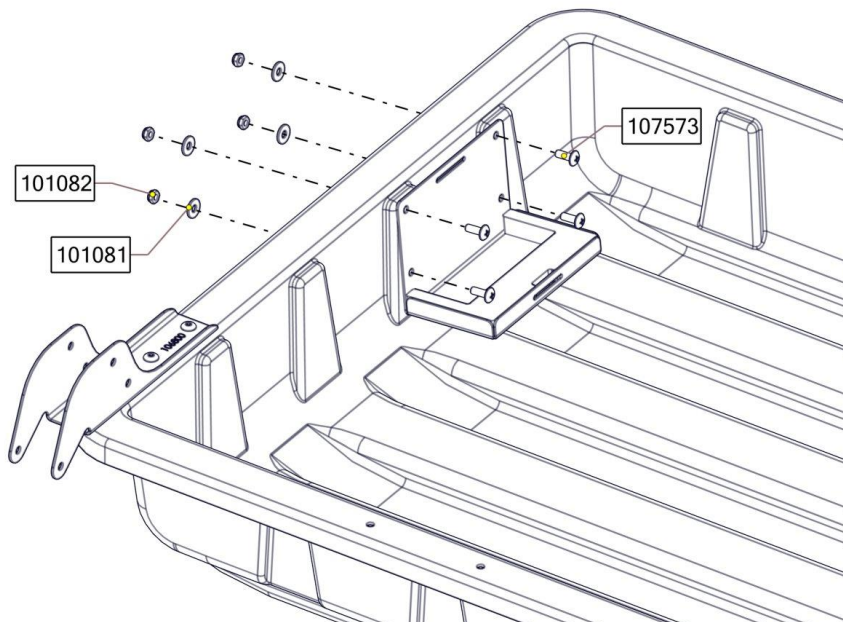

STEP 7 – CANOPY SUPPORT POLES

NOTE: During installation, ensure that all Support Poles (#107498 and #103599) have slots facing inward.

Parts Needed for Step 7

Part Number	Description	Quantity
107498	BENT PORCH SUPPORT POLE	2
103599	STRAIGHT CANOPY SUPPORT POLE	4
106331	SCREW, 1/4-20 X 2.50	6
106284	NUT, 1/4-20, NYLOCK	6

- A.** Install Bent Porch Support Poles #107498 on either side to the bottom position of the Mounting Bracket using #106331 bolts and #106284 nuts (see photos below).
- B.** Once Bent Porch Support Poles are secured on both sides, install Straight Canopy Support Poles #103599. **TIP: All support poles should be snug, but not too tight as they need to be able to move freely.**

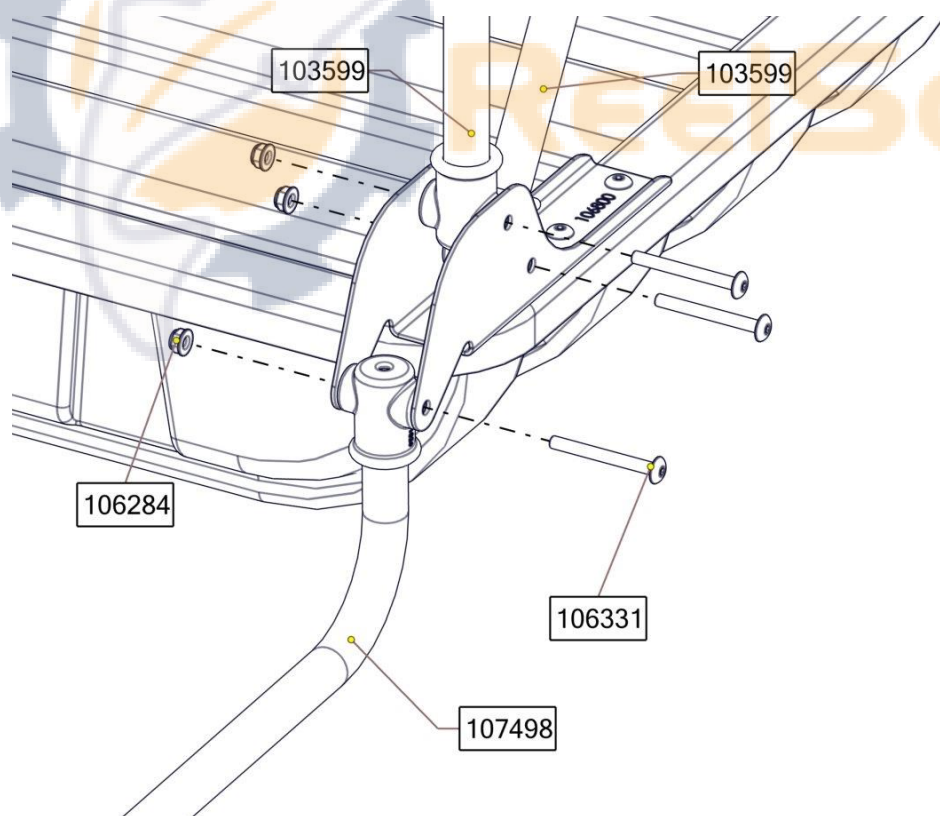

Slots in poles must face inward as shown below.

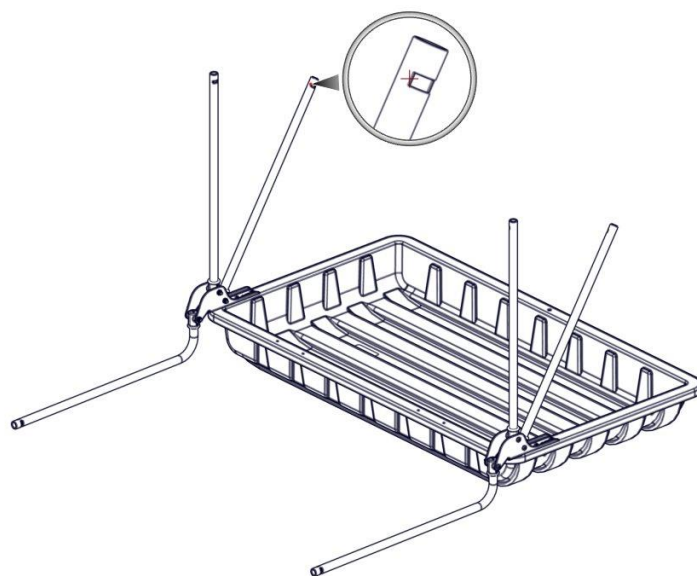

STEP 8 – HOOP POLES

Parts Needed for Step 8

Part Number	Description	Quantity
107469	HOOP POLE	1
103605	LARGE RPSX COLLAR	4
101840	REAR SPREADER POLE	1
N/A	EXTENSION HOOP POLE ASSEMBLY (From Step 3)	1

- A. Put RPSX Collars #103605 onto one Hoop Pole #107469.
- B. Install one Hoop Pole onto the BACK pair of support poles.
- C. Next, install the Extension Hoop Pole Assembly from Step 3 to the next set of support poles.
- D. Clip the Rear Spreader Pole #101840 to the frame of the shelter.

COMPLETED HOOP POLE ASSEMBLY AT THIS POINT SHOULD MOVE FREELY AND LOOK LIKE THE DIAGRAM BELOW.

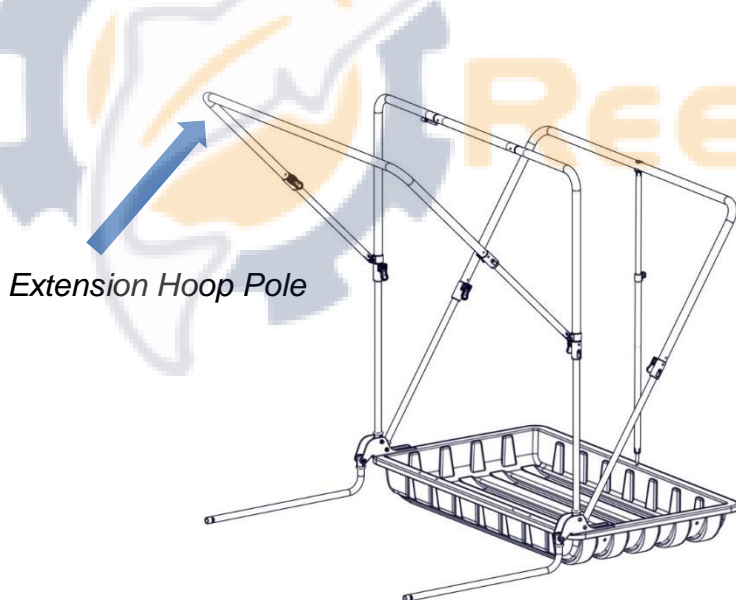

Slide Hoop Poles over Canopy Poles and lock with RPSX Collars

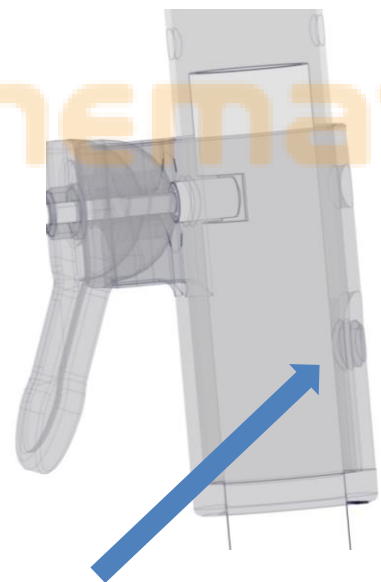

! DO NOT INSTALL FRONT HOOP (PORCH) POLE AT THIS TIME. THIS WILL BE DONE DURING THE TENT INSTALLATION STEP.

TIP: Run electrical tape around RPSX collar tab to help prevent the tab from twisting or slipping.

STEP 9 – PUTTING SEATS IN SHELTER

- A. Install seat assemblies into shelter as shown, noting the seat latch clip position. Chair needs to be in the lock position when sitting. It's also important to have the seats in place for added weight to help with the tent installation process.

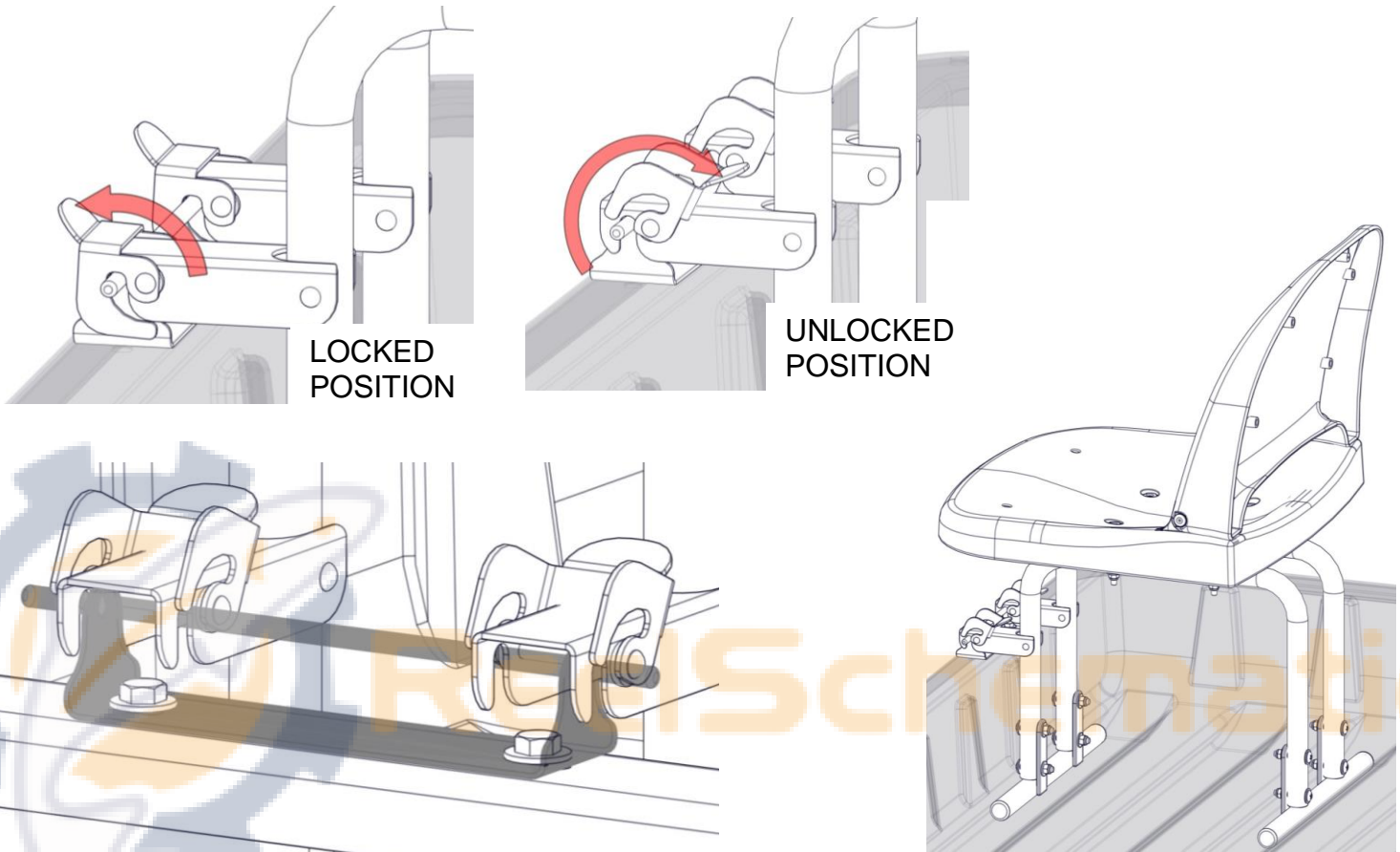

STEP 10 – TENT INSTALLATION

****FOR AN ALTERNATIVE OPTION ON INSTALLING THE TENT, PLEASE REFER TO THE SETUP VIDEO INSTRUCTIONS FOUND THROUGH THE QR CODE ON PAGE 1 OF THIS MANUAL****

Parts Needed for Step 10

Part Number	Description	Quantity
107471	TENT, RANGER XT THERMAL	1
102814	U-CHANNEL	1
101148	SCREW, #6 X 0.38	23

TIPS FOR INSTALLING TENT

- For best results, set tent in a warm environment.
- Use of a cordless drill is advised for installing U-channel screws.
- Before installing tent, place a heavy weight in the center of the base to ensure proper tent installation.
- Do not leave spreader pole attached while installing tent. Only use it for placing tent over the shelter's frame during the assembly process.

- A. Drape the tent over the Hoop Poles. Attach the tent to the poles on the inside with the Velcro straps.
- B. Slide the remaining front Hoop Pole through the sleeve in the front of the tent.

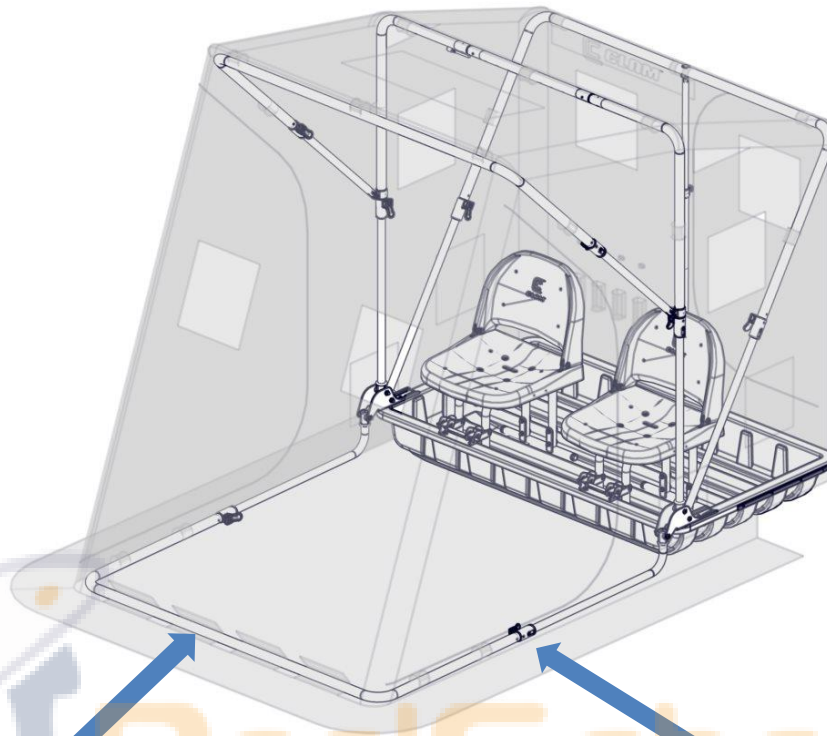

Slide remaining
Hoop Pole
through sleeve in
front of tent

Connect Hoop
Pole to Bent Porch
Support Pole



Soaking the U-Channel Molding #102814 in hot water will make it pliable and easier to wrap around shelter.

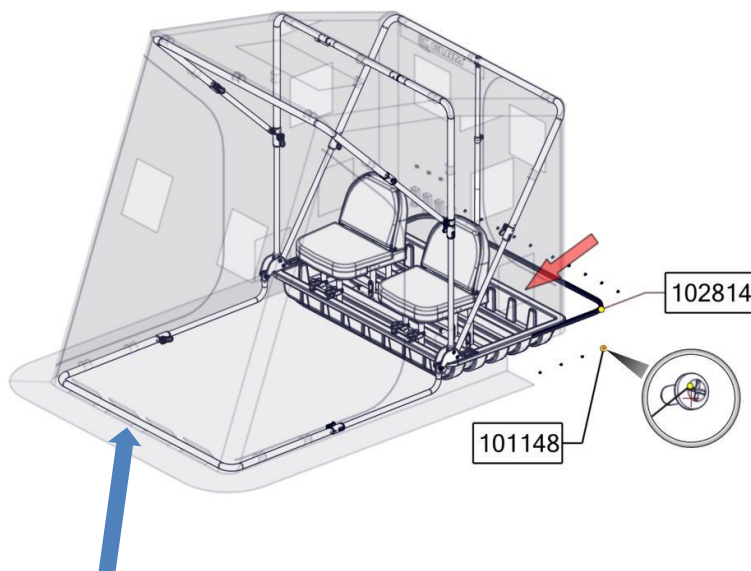

THE FRONT HOOP POLE SHOULD TOUCH THE FLOOR WHEN THE TENT IS SET CORRECTLY WITH SOME SLACK IN THE FRONT PART OF THE TENT



REMOVE SPREADER POLE WHILE INSTALLING U-CHANNEL

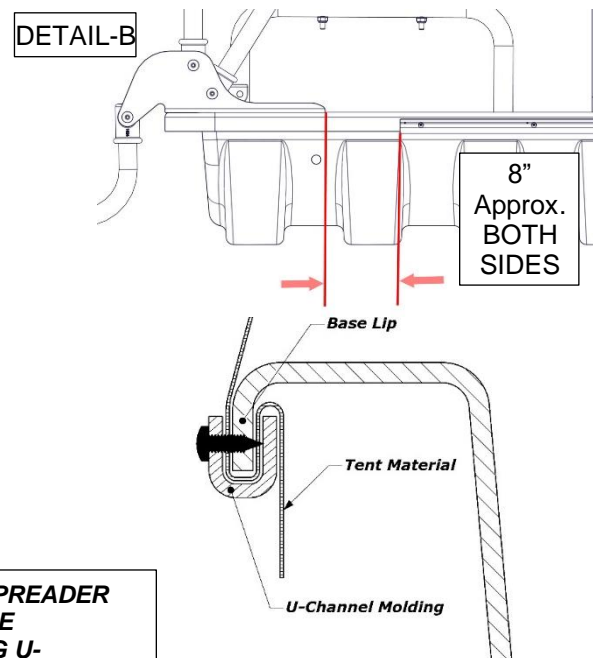

- C. After connecting the Velcro tent loops to the frame, pull tent material over the back of the base and temporarily attach using clamps.
- D. Walk around the shelter to verify the tent is fitted to the frame properly and adjust as needed before continuing.
- E. To properly set the tent, pull down on the rear corners of the tent to adjust the front hoop pole position. When set correctly, the front hoop pole should touch the floor and the tent material should have some slack. Once satisfied with how the tent is sitting, re-clamp rear corners to maintain proper position of the tent.
- F. Before installing U-Channel #102814, place in hot water for a minimum of two minutes or until molding is pliable.
- G. Find rear midpoint of the shelter and center of U-Channel. Press the middle of the molding over tent material and base lip (see Detail "A"). Insert one #6 phillips screw #101148 into the center of the U-Channel molding. Next, press the molding in around the base. There should be an 8" gap from the end of the U-Channel to the back of the Mounting Bracket, so it may be necessary to cut the channel (see Detail "B").
- H. Install remaining screws through U-Channel until it is fully secured to the base and is holding the tent tight to the tub.

TIPS FOR USE

Folding and transporting your Clam Ice Fishing shelter is easy:

- Unsnap the spreader pole and lay it in the bottom of the base.
 - Push the RPSX Collars and retract each hoop, starting with the rear hoop and working towards the front. Rotate all retracted hoops to the resting position. Tuck the tent into the base and between the hoops so that no material is left hanging on the ground for transport.
 - Cover with the travel cover to help prolong the life of the unit.
 - We recommend the optional Runner Kit be mounted to the base of your shelter
- NOTE: Pulling behind an ATV or snowmobile may result in premature wear of the base.**
- In windy conditions it is advised to secure your shelter to the ice using Clam's Ice Anchor Kit (part #108064) and Ice Anchor Installation Tool (part #108348).

Make sure your shelter is completely dried out after each use. Store your shelter in a cool, dry place. Keep away from rodents.

Q: What is the proper way to set up and take down my Fish Trap?

Set-Up:

- Face the seats. Grab the floor hoop pole and pull on it until you feel and hear the RPSX collar pins engaging in the fully open position. Grab the next hoop and do the same until all the hoops are fully open. When finished, you should be inside the shelter.
- Install the roof spreaders, then front spreader, and finally the rear spreader. (Spreader count varies with shelter style/configuration – some smaller shelters use only a rear spreader).

Take-Down:

- Remove all spreaders - snug the tension knobs after compacting so they don't vibrate out during transit.
- From inside the shelter, start with the rear wall hoop. Compress both collars and retract hoop, then the same with next inward hoop, etc. Continue until all upright hoops are collapsed.
- Step out of the shelter, disengage the porch hoop collars and swing the porch hoop onto the previously retracted hoops. Make sure the tent does not catch on the mount brackets while collapsing the porch hoop.
- Go around the shelter and tuck the tent material in between the rested hoops the best you can to keep the tent material from dragging during transit – a travel cover works great to help hold everything together.

***Note: Make sure tent material is clear of the canopy brackets to minimize rubbing or possible tearing.

SAFETY INSTRUCTIONS



Please fully understand and follow all safety instructions as outlined. Failure to do so could result in severe injury or death.

•DO NOT USE OPEN FLAME HEATERS IN YOUR ICE SHELTER. INJURY OR DEATH MAY RESULT FROM FIRE IF TENT FABRIC IS EXPOSED TO OPEN FLAME. THE TENT IS NOT FIREPROOF, BUT THE FABRIC IS TREATED WITH A FIRE RETARDANT THAT MEETS CPAI-84 SPECIFICATIONS. APPLICATION OF ANY FOREIGN SUBSTANCE MAY RENDER THE FLAME RETARDANT PROPERTIES INEFFECTIVE. TENT FABRIC WILL MELT WHEN CONTACT IS MADE WITH HOT SURFACES (I.E., HEATERS).

•DEATH FROM ASPHYXIATION MAY RESULT FROM USE OF OXYGEN DEPLETING HEATERS. OPEN ALL VENTS FOR FRESH AIR VENTILATION.

•NEVER LEAVE SHELTER UNATTENDED WHEN SET UP.

•DUE TO THE INCREASE IN TRAFFIC (SNOWMOBILES, AUTOS, ETC.) ON AREA LAKES, ICE FISHING CAN BE HAZARDOUS AT NIGHT. IF YOU CHOOSE TO FISH AT NIGHT OR IN POOR VISIBILITY CONDITIONS, BE SURE TO TAKE PRECAUTIONS WITH LIGHTS OR REFLECTORS TO SHOW DRIVERS YOUR WHEREABOUTS. NIGHTTIME: EXTERIOR REFLECTORS MUST BE VISIBLE TO REDUCE RISK OF COLLISIONS.

FREQUENTLY ASK QUESTIONS

Fish Trap FAQ's

Q: Should I install a runner kit/hyfax to the base of my shelter?

A: The warranty on our shelters does not cover cracked or worn bases if a runner kit has not been installed. Additionally, bases will wear much quicker without a runner kit installed.

Q: The zipper on my shelter freezes up and/or sticks. Is there anything I can use to help prevent this from happening?

A: There are lubricants available that can work well, including various silicone sprays, ChapStick and other zipper lubricant sticks and brushes.

Q: The sliding seat poles, frame poles, or spreader poles of my shelter are sticking. Is there anything to put on these poles to help them slide better?

A: Silicone spray lubricants can help prevent poles from sticking. When poles slide against each other sometimes burrs are created. If this happens separate the affected poles and use a fine file or sandpaper to deburr the pole(s) and then apply a thin coat of lubricant before rejoining the poles.

Q: Do you have a replacement tent, base, poles, quick connects or other parts for my Fish Trap?

A: Retailers typically don't carry replacement parts, but we have replacement parts available for purchase direct at www.clamoutdoors.com. We are limited on parts for older model shelters.

Q: The poles to my Fish Trap have bent out of place. Should I try to bend them back?

A: It might be possible to bend the poles back into their proper place. If your bent pole is not creased lay it on a flat surface and bend it back into shape. Replacement poles can be ordered online from our website if needed.

Q: Should I put screws through the U-channel molding and tent of my shelter?

A: Putting screws through the U-channel will help to securely fasten the tent of your shelter to the base. This is a necessary step for proper installation and failure to do so will void the warranty.

Q: I am trying to attach the U-channel molding to my shelter, but am having difficulty getting it started, as it seems too stiff and will not stay attached to the edge of the sled. What can be done to help?

A: It is difficult to attach the U-channel in cold conditions. Assembly of the shelter should be done indoors with the U-channel warmed in a bucket of hot water for several minutes so it's more pliable.

Q: I can see pinholes of light through the fabric of my tent. Is my shelter waterproof and will my fish house leak?

A: Pinholes may be seen along seams or where the tent fabric is bonded to the thermal material on an insulated shelter. In either case, this has no effect on the function of the fabric or performance of the unit. While the fabric of the tent is water resistant it is not waterproof, so some water from rain or melting snow may come through your tent. A waterproofing spray such as Kiwi Camp Dry can be applied to the tent fabric to make the shelter more water repellent.

Q: There are cracks on the inside finish of the fabric of my shelter. Is this normal? Can anything be done to fix this?

A: It is normal for some of the dark colored coating to come off the inside of the tent, particularly on a non-thermal tent. Over time, as you set up and take down the shelter, the dark coating can

begin to flake off, especially along the folds in the fabric when the shelter is collapsed. This does not affect the function of the fabric. If you feel that too much light is now entering your shelter in the places where some of the coating has come off, you may wish to apply a new layer of rubberized coating. A thin layer of Loctite Color Guard (black), found online or at home improvement stores, works well.

Q: Would it be best to completely dry out my shelter after every time it gets used?

A: It is recommended your tent be dried out completely after each use. If it is not dried out, moisture may cause some damage to the shelter. This is especially important if the shelter is being stored for a long period of time.

Q: What will help keep mice or rodents from eating the tent of my Fish Trap?

A: We recommend keeping your tent in a sealed plastic tote with laundry dryer sheets or moth balls. If the shelter is stored in a barn or shed, take the tent off and store it in a more rodent-free environment.

Q: How do I wash the tent of my ice fishing shelter?

A: We recommend using a mild bleach and water solution (1 part bleach to 10 parts water), or a mild soap detergent and water solution to help get rid of mildew and odor in your tent. Be sure to dry the tent thoroughly. We do not recommend using a washing machine to clean the tent as it may cause damage.

Q: Will using a heater help to eliminate or reduce water vapor and condensation in my shelter?

A: No. A byproduct of burning propane is water. A bigger heater will produce more water vapor. Also, the colder the temperature outside the more condensation there will be inside the unit.

Q: Are patch kits available and how do I apply them to my shelter?

A: Yes, patch kits are available for purchase on our website. When applying a patch, it works best to spray adhesive (we recommend using 3M #77 or 3M #90 spray adhesive) on to both surfaces - the part of the tent where the patch is going to be applied and the patch itself. Wait until the adhesive begins to dry and becomes tacky, then place the patch on the tent. Make sure to apply the patch evenly and smoothly since wrinkles or uneven areas will be very difficult to correct once the two surfaces with the adhesive come into contact with each other.

Q : Do you ship outside of the United States?

A: We can ship to Canada, but note that all prices on our website are listed in US dollars. Canadian orders will include the cost of the item plus shipping, taxes & duties.